

AUTOMOBILES & SMALL UTILITY VEHICLES LOADING AND UNLOADING

VEHICLES NEED NOT ENTER MARSHALLING YARD. THIS IS A REFERENCE POINT ONLY.

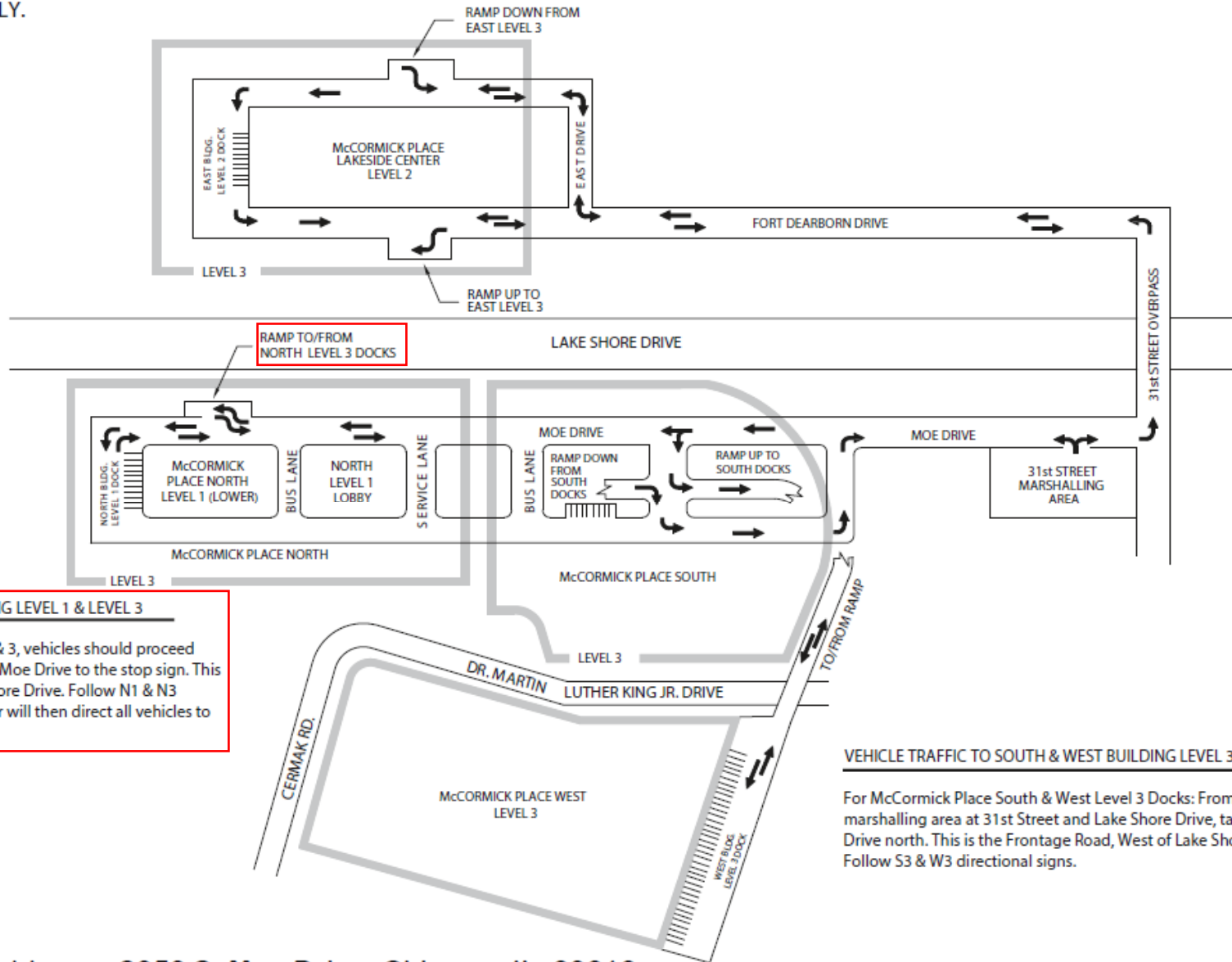
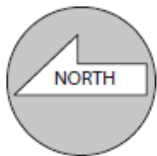

VEHICLE TRAFFIC TO LAKESIDE CENTER LEVEL 2 & LEVEL 3

To reach the Lakeside Center (East Building), vehicles will leave the Marshalling Yard and travel over the 31st Street Overpass to Fort Dearborn Drive. This is the Frontage Road, East of Lake Shore Drive. Follow E2 & E3 directional signs.

VEHICLE TRAFFIC TO NORTH BUILDING LEVEL 1 & LEVEL 3

For McCormick Place North Levels 1 & 3, vehicles should proceed north out of the Marshalling Yard on Moe Drive to the stop sign. This is the Frontage Road, West of Lakeshore Drive. Follow N1 & N3 directional signs. A traffic coordinator will then direct all vehicles to the proper loading/unloading area.

VEHICLE TRAFFIC TO SOUTH & WEST BUILDING LEVEL 3 DOCKS

For McCormick Place South & West Level 3 Docks: From the marshalling area at 31st Street and Lake Shore Drive, take Moe Drive north. This is the Frontage Road, West of Lake Shore Drive. Follow S3 & W3 directional signs.

Marshalling Yard Address: 3050 S. Moe Drive, Chicago, IL 60616

**McCORMICK PLACE
VEHICLE TRAFFIC ROUTES**